

**GGN**

# Concepts Update

**Hemisfair Tower Park**

May 11, 2021

**Tower Park is a  
Community Park at Hemisfair**

**What Is this Place? (Hemisfair)**



Civic Park  
+ P3

Yanaguana  
+ P3

Tower Park  
+ P3

# Before Hemisfair - Where the Neighborhoods Met Downtown

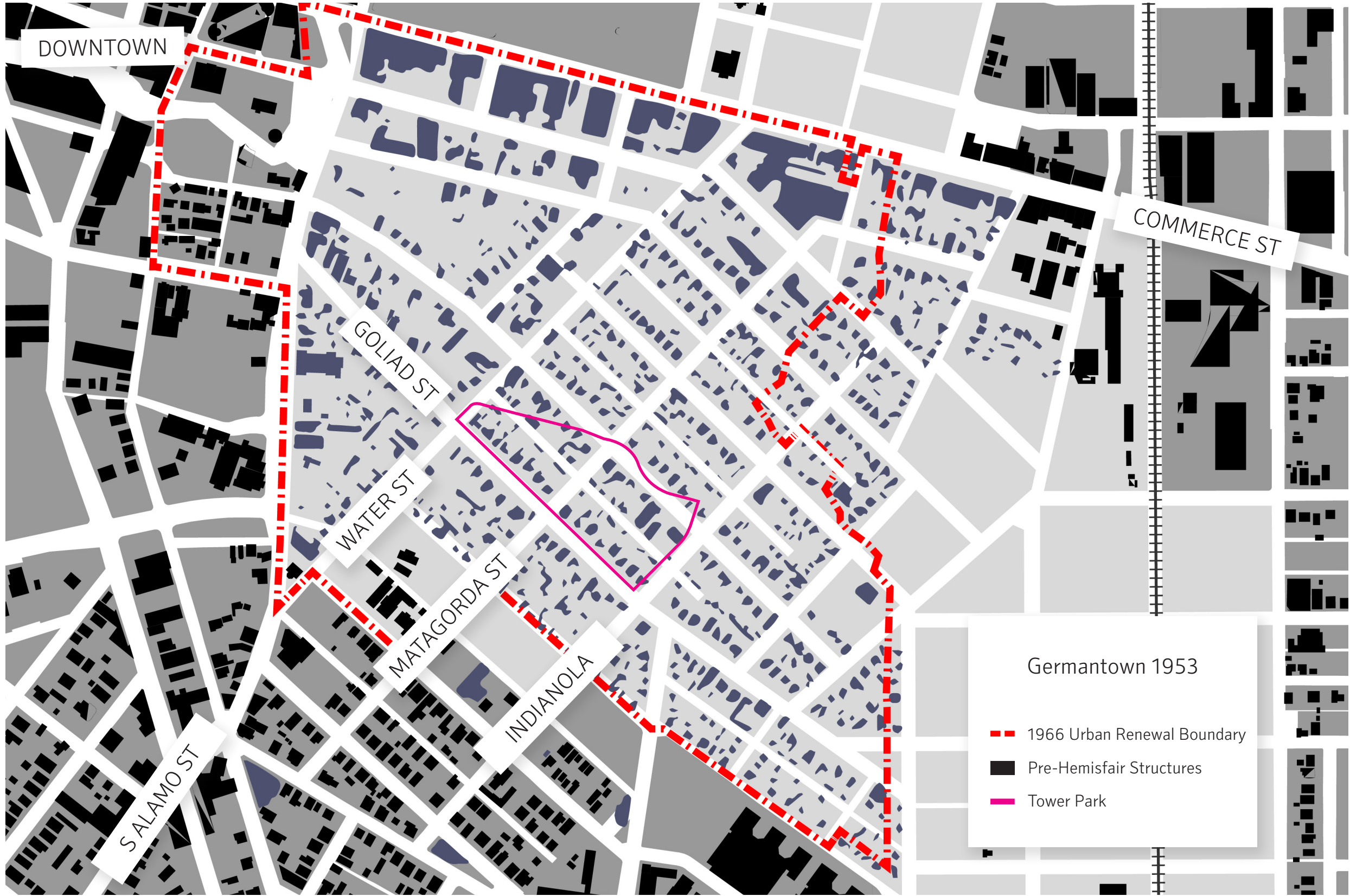

# Before Hemisfair - A Human-Scale Urban Fabric

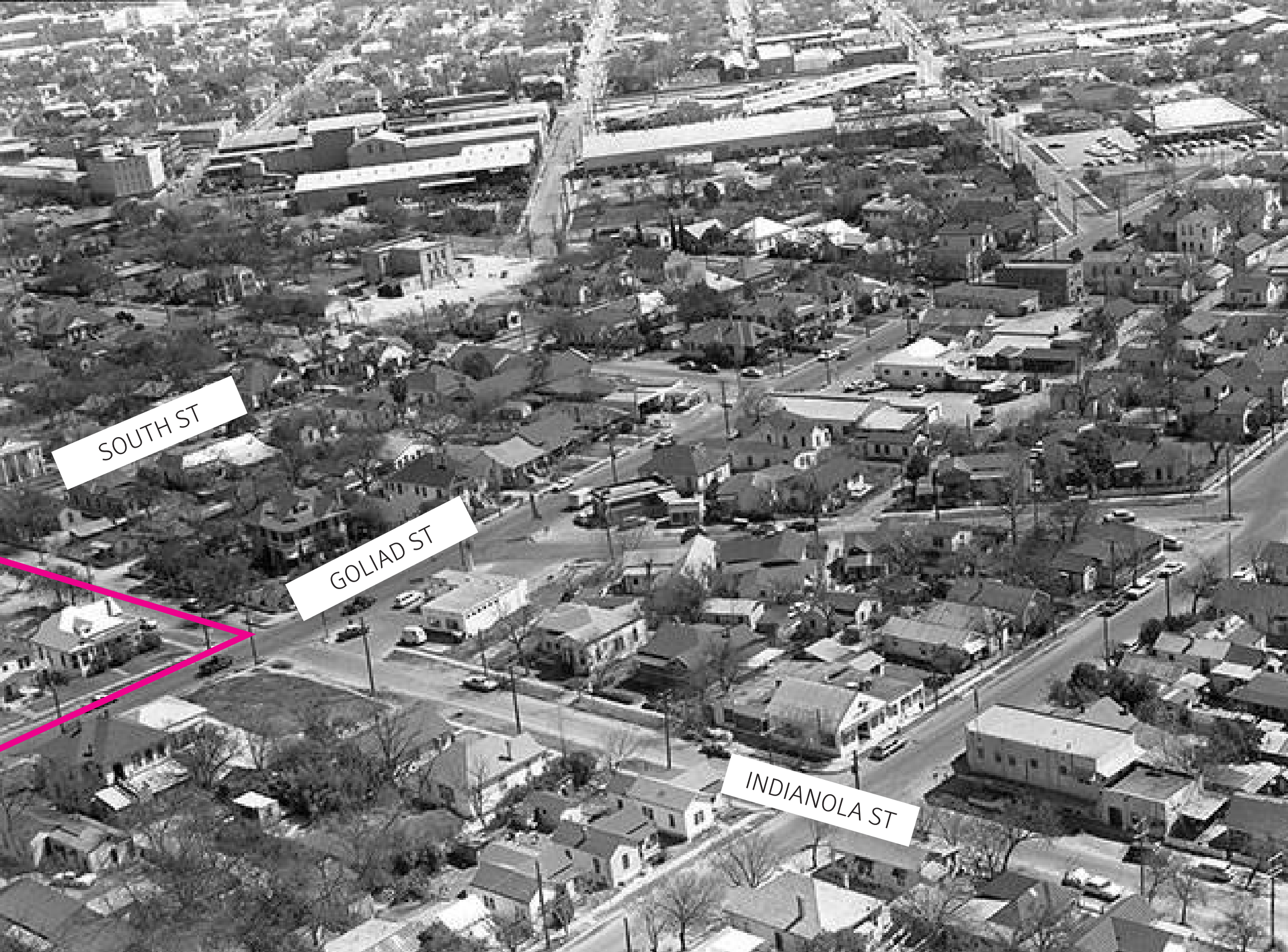

Tower Park Site



# Before Hemisfair - Hemisfair Park Has Lost the Neighborhood Grain



# Remains of Germantown Today - Historic Icons Have Lost Contact with the Street

Historical

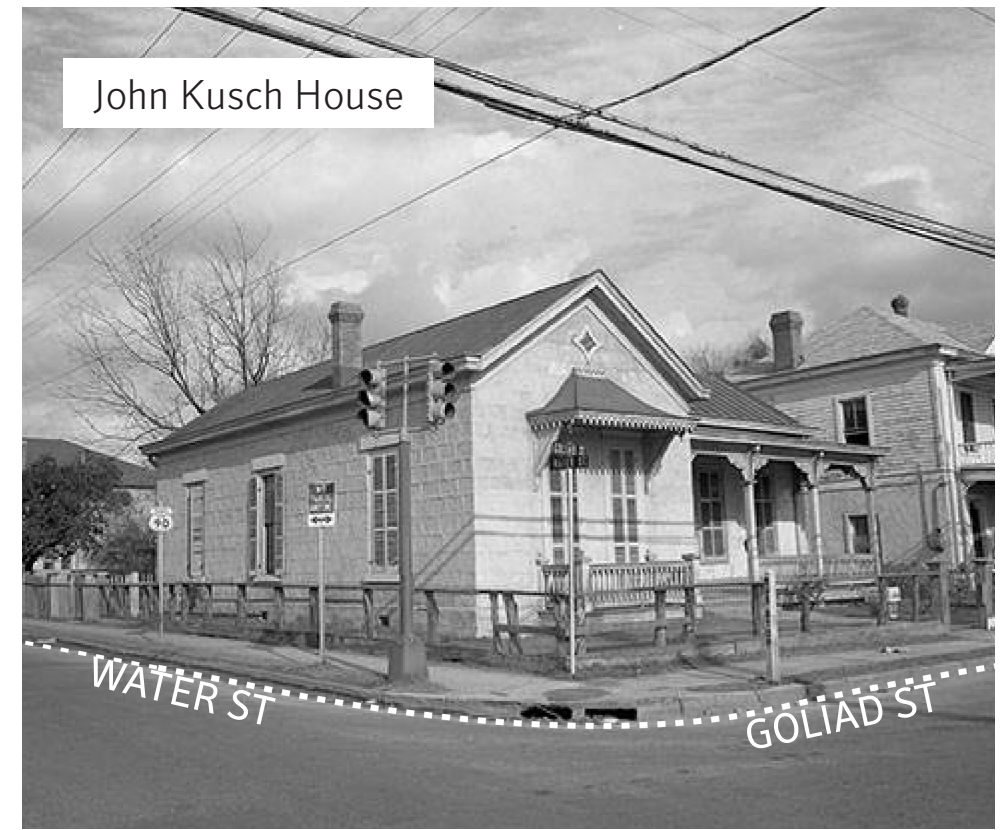
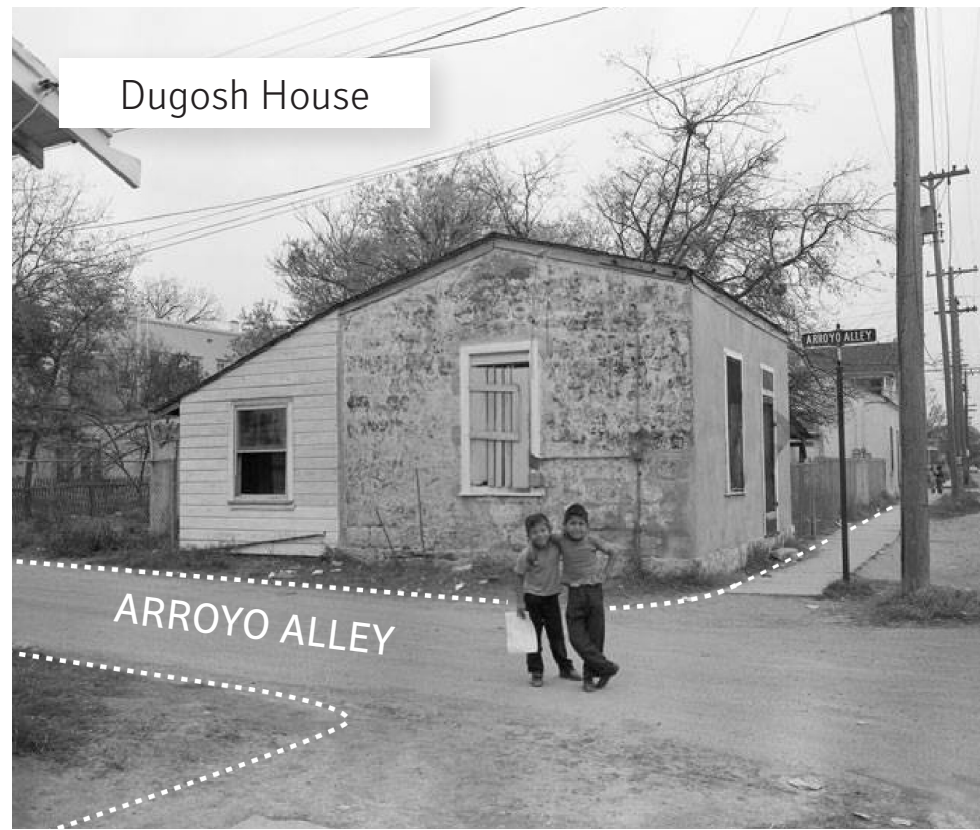

Current





# Hemisfair '68 - At Tower Park



# Hemisfair '68 - An Island and Raised Walkway Around the Tower



**During Hemisfair**

- Raised Structures
- Hemisfair Water Feature



**Current**

- Overlay Raised Structures
- Overlay Hemisfair Water Feature

# After Hemisfair '68 - Making Sense of What Was Left Behind

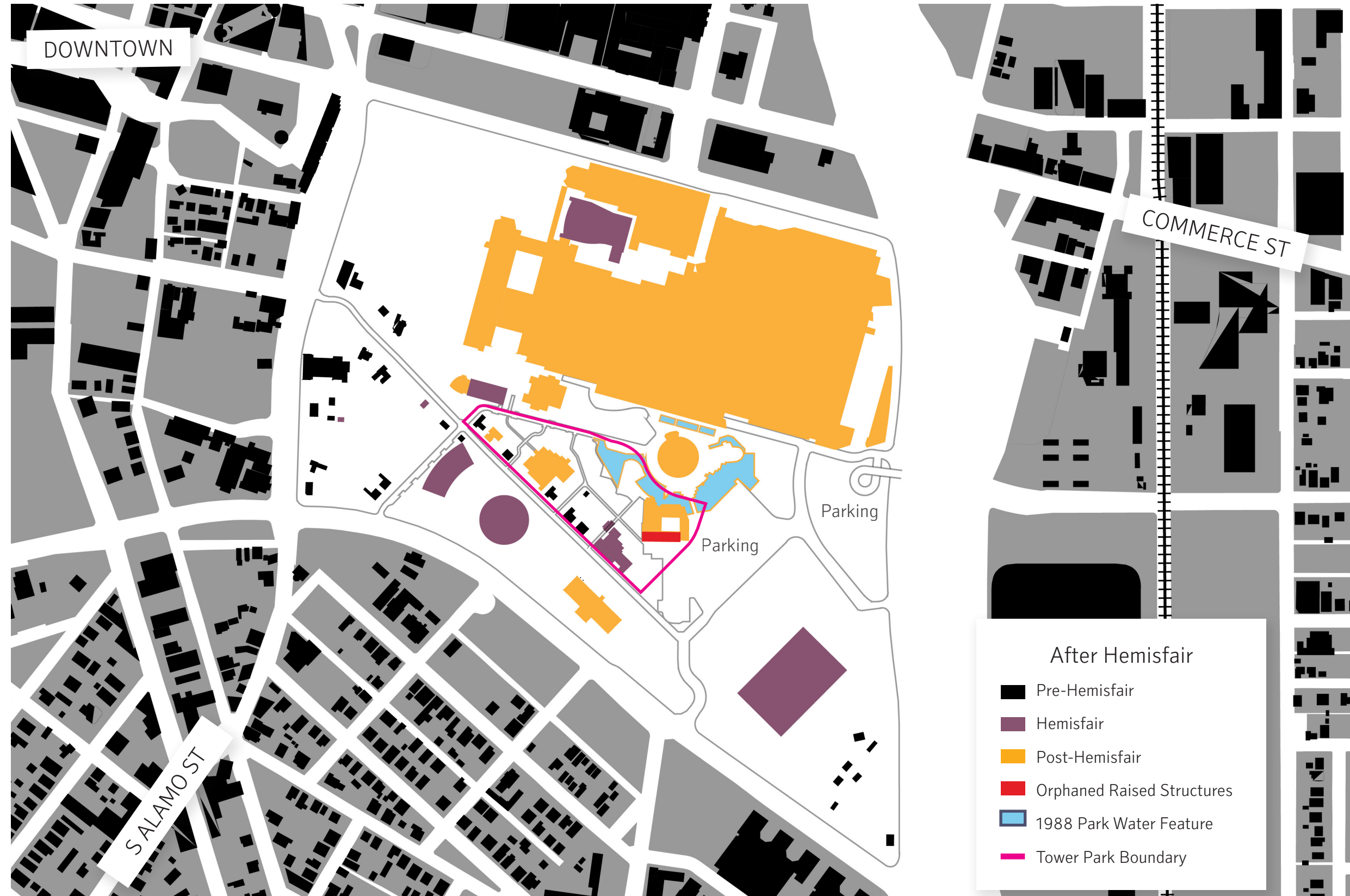

## After Hemisfair '68 - Community Once Worked to Turn Hemisfair into a Neighborhood Park



1986: Leather Associates and Local Kids



1986: Volunteers Building Playground



1988: Hemisfair Park Volunteer Tree Planting

## After Hemisfair '68 - Community Volunteers Work to Turn Hemisfair into a Neighborhood Park



# Hemisfair Park Site Logics

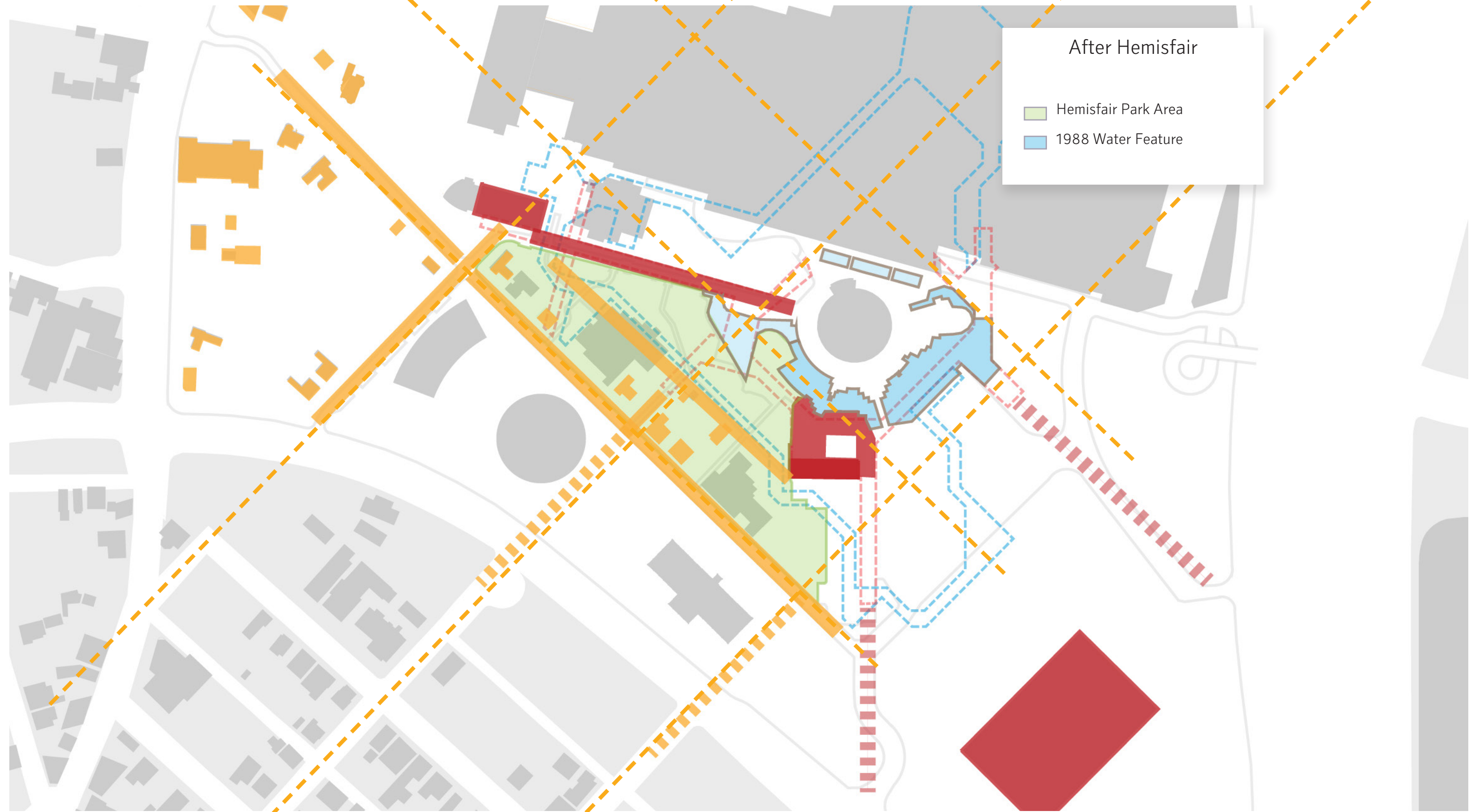

**What Kind of Park?**

**Balanced Green Space**  
**Reflecting on History**  
**Local Arts & Culture**  
**Neighborhood Conveniences**  
**Health & Wellness**  
**Food Options**  
**Local Entrepreneurship**  
**Amenities**  
**Connectivity**



# PPS - Program Relationship and Layout

## Proposed Destinations

Using information gathered during the public engagement phase, preliminary recommendations for the program of uses at Tower Park are illustrated here.

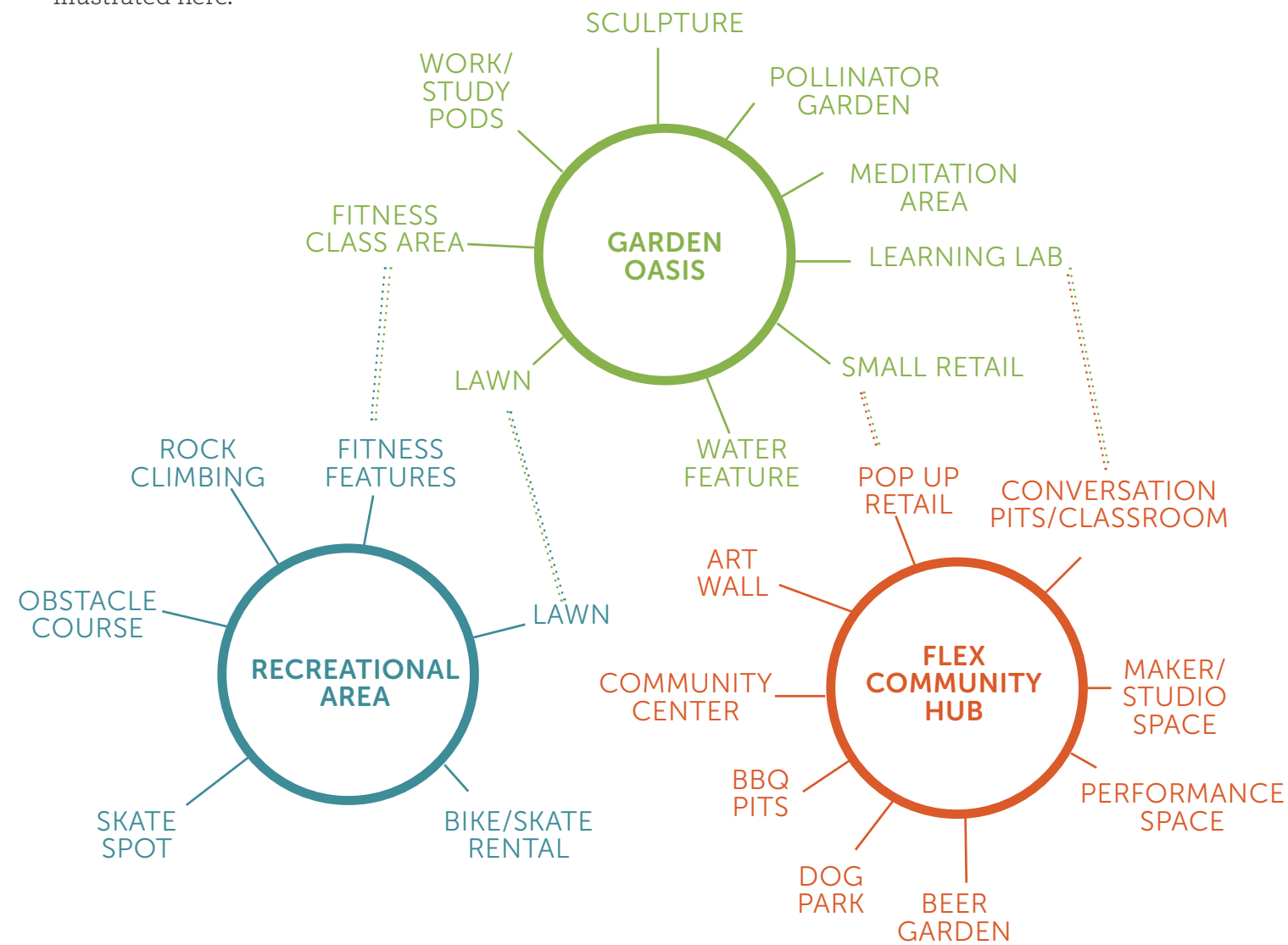

## SITE-WIDE FEATURES

- Jogging/walking/strolling path/trail connecting the whole park
- Creative tree lighting
- Fun seating
- Shade
- Iconic focal point
- Art installations
- History panels
- Color!

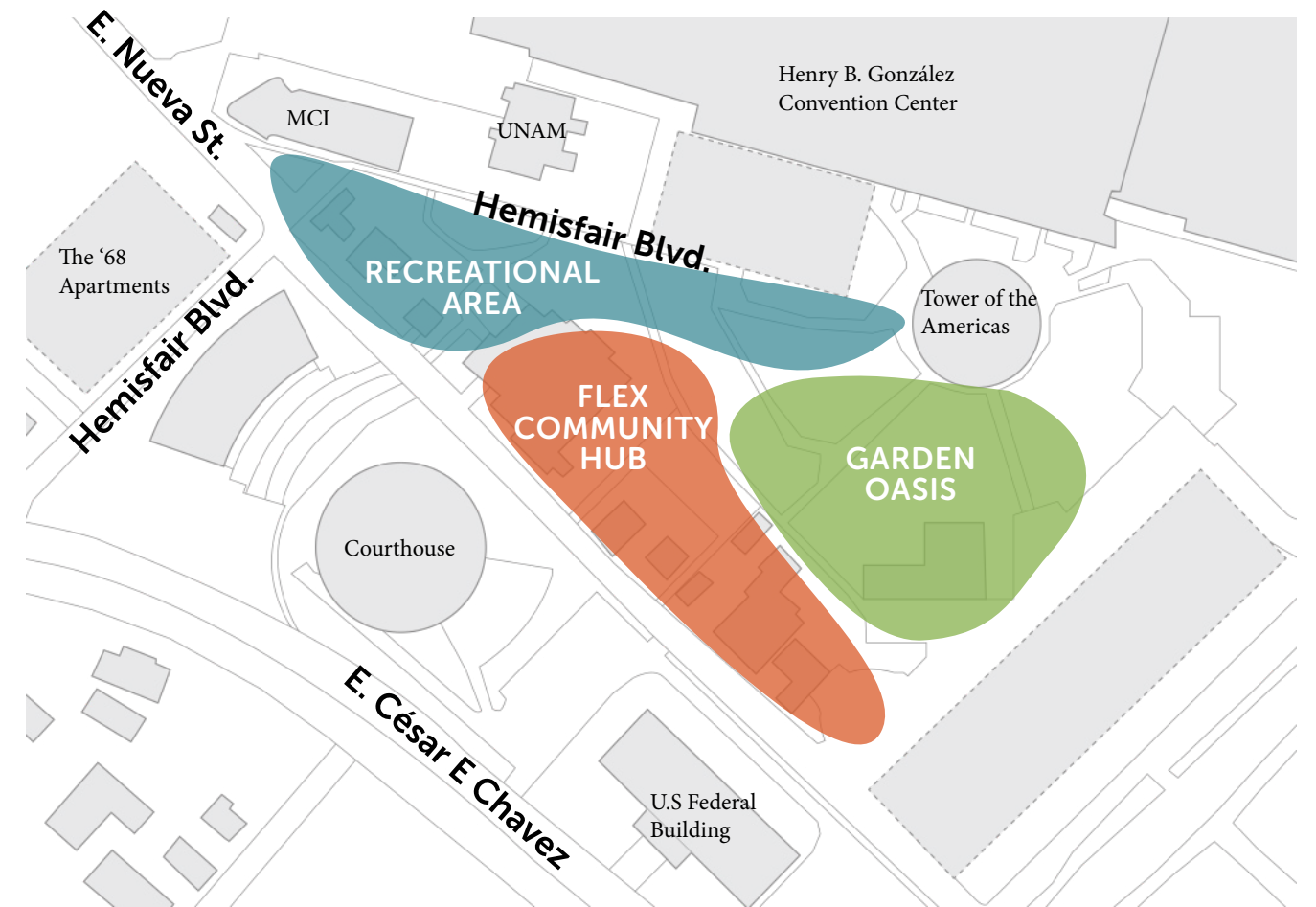

# Program - Opportunities and Discoveries

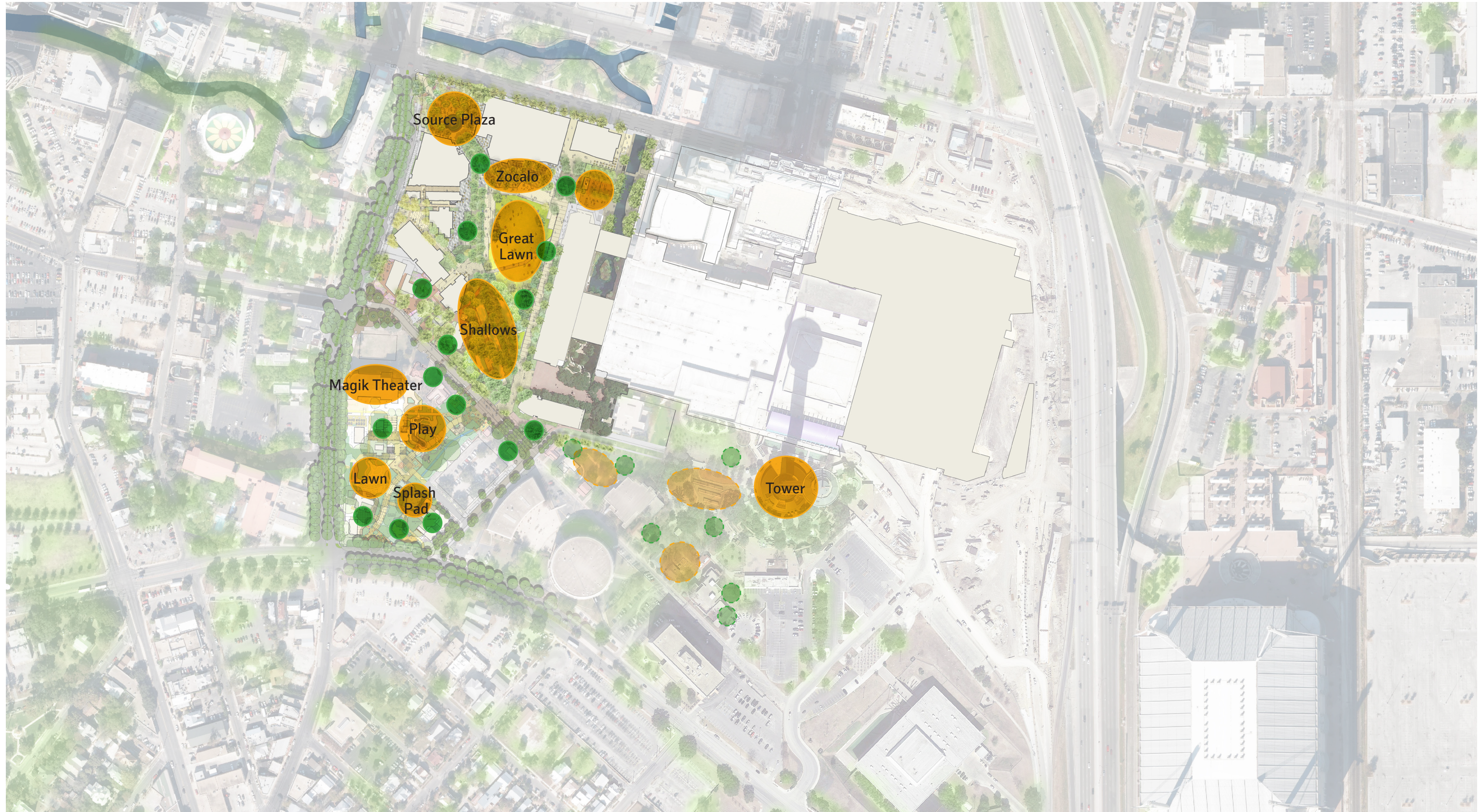

Community

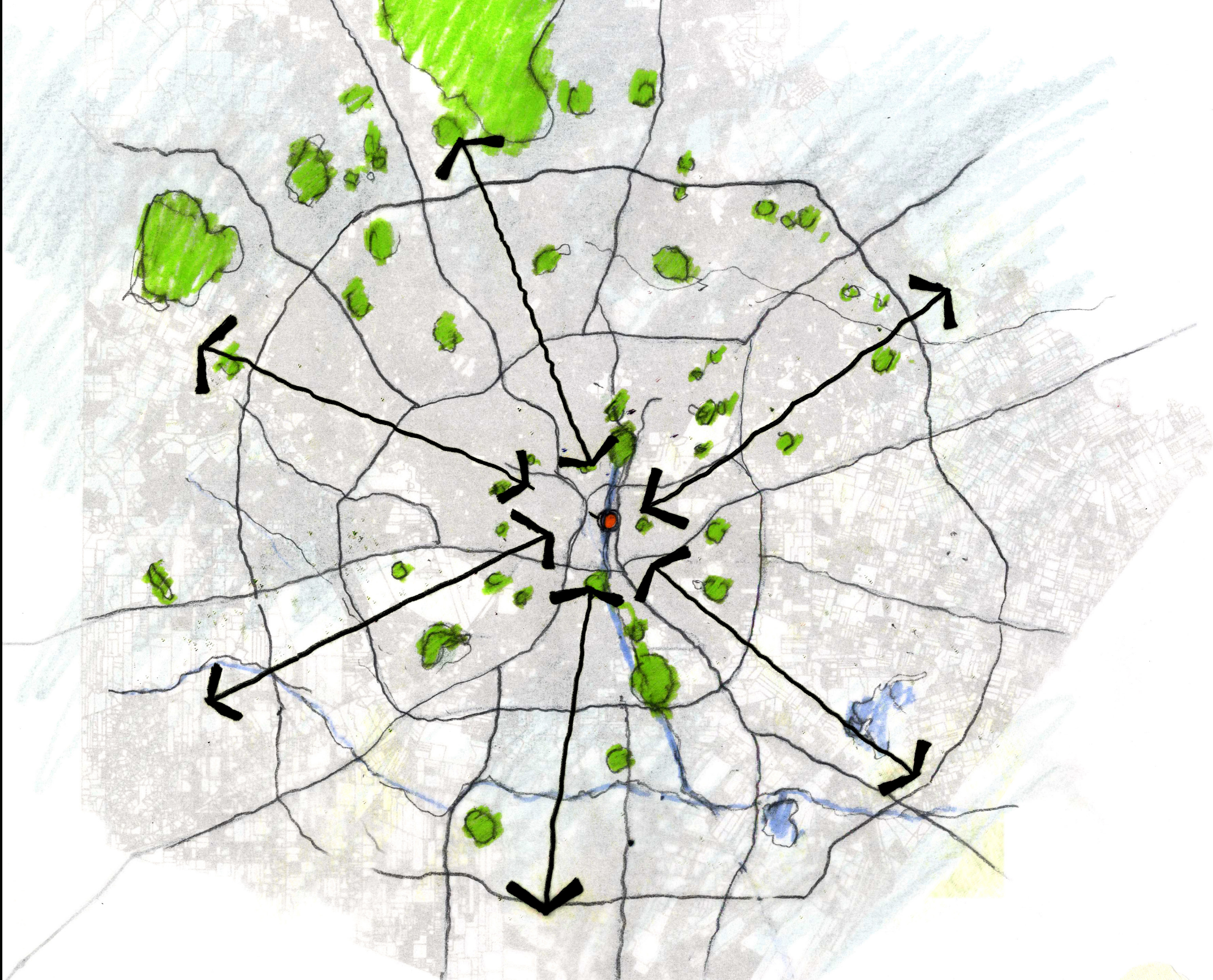

# Hemisfair Connects the City



# Neighborhood Network

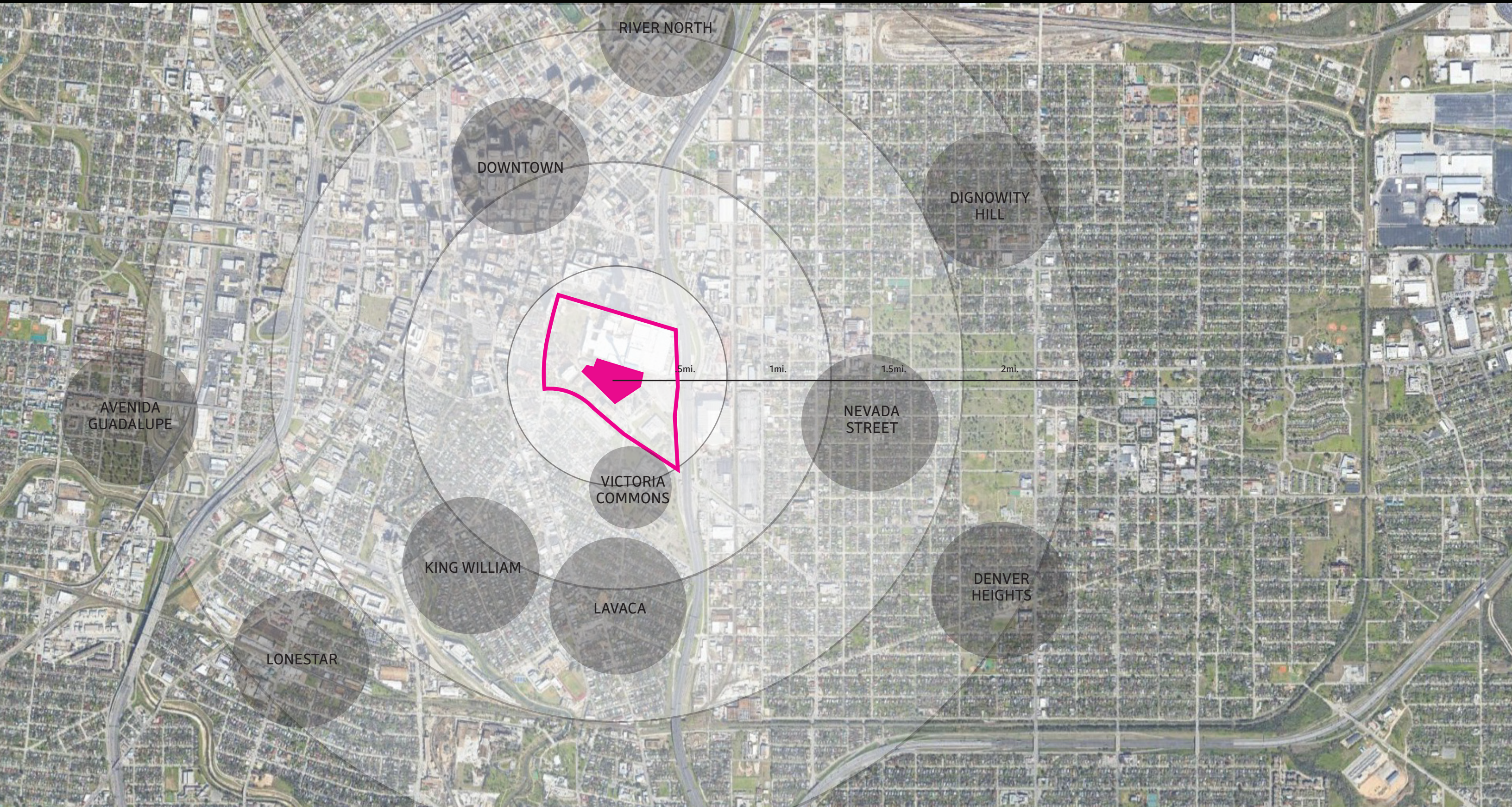

## Neighborhood Context - Denver Heights

Back to Denver Heights - Local writer Cary Clark returns to the near East Side neighborhood where he grew up, and finds a community in transition.

<https://saheron.com/back-to-denver-heights/>

“Neighborhood history is preserved in stories told and retold until they have become legend and myth. But when the storytellers pass or move away, when the front porch is less crowded, and when the stories being told and the memories no longer shared, who remembers its history?”



Old photos of The Keyhole decorate The Dakota East Side Ice House, 433 S. Hackberry St. Photo by Ben Olivo | Heron

## Neighborhood Context - Denver Heights

Back to Denver Heights - Local writer Cary Clark returns to the near East Side neighborhood where he grew up, and finds a community in transition.

<https://saheron.com/back-to-denver-heights/>

“Back in that day, there were places like the icehouse on the corner of East Commerce and South Pine, across the street from the Friedrich building. It was a lively gathering place for people in the neighborhood to buy snacks, tamales, sausage, soda, beer; play dominos and enjoy the jukebox’s soulful selection.”



Modern Day Convenience stores - Icehouses are scattered throughout South Texas, but San Antonio is the acknowledged world capital.



## Neighborhood Context - Denver Heights

Back to Denver Heights - Local writer Cary Clark returns to the near East Side neighborhood where he grew up, and finds a community in transition.

<https://saheron.com/back-to-denver-heights/>

"A few blocks away [...] was a cluster of famed East Side businesses known as "The Corner," an intersection of culture and commerce at Pine and Iowa streets. Anchoring "The Corner" were W. H. Leonard's Drug Store, a movie theater, a gas station and The Keyhole, one of the first integrated nightclubs in the South."



W.H. Leonard's Pharmacy on Pine Street

# Anatomy of a Neighborhood



Community

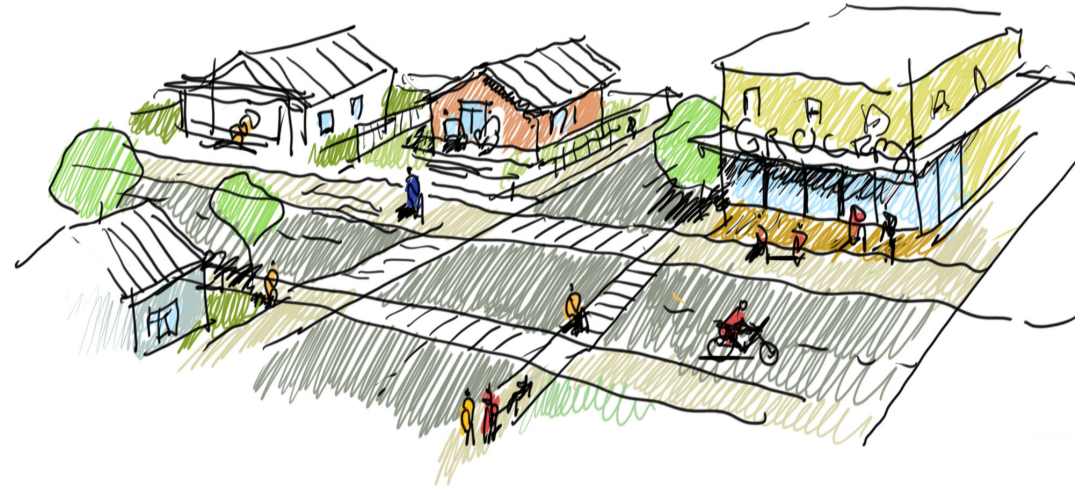

+

Park

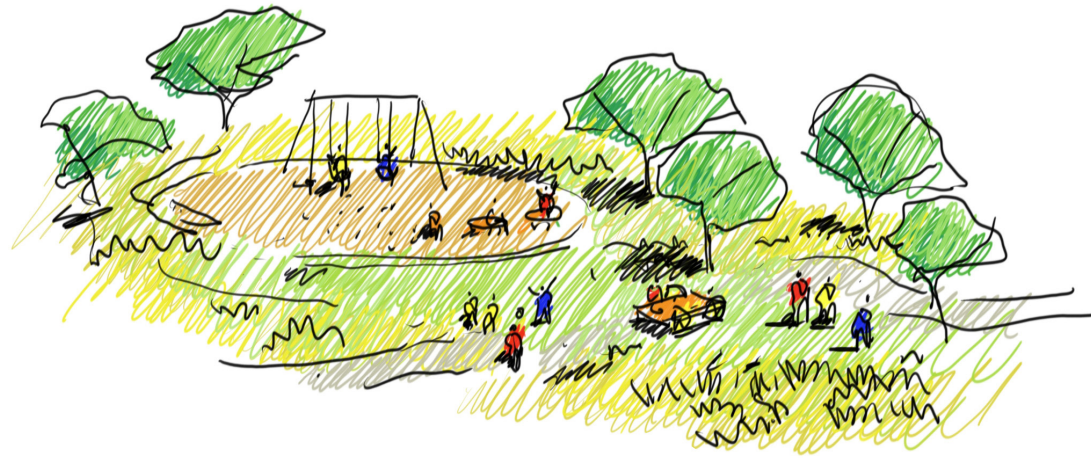

+

Hemisfair

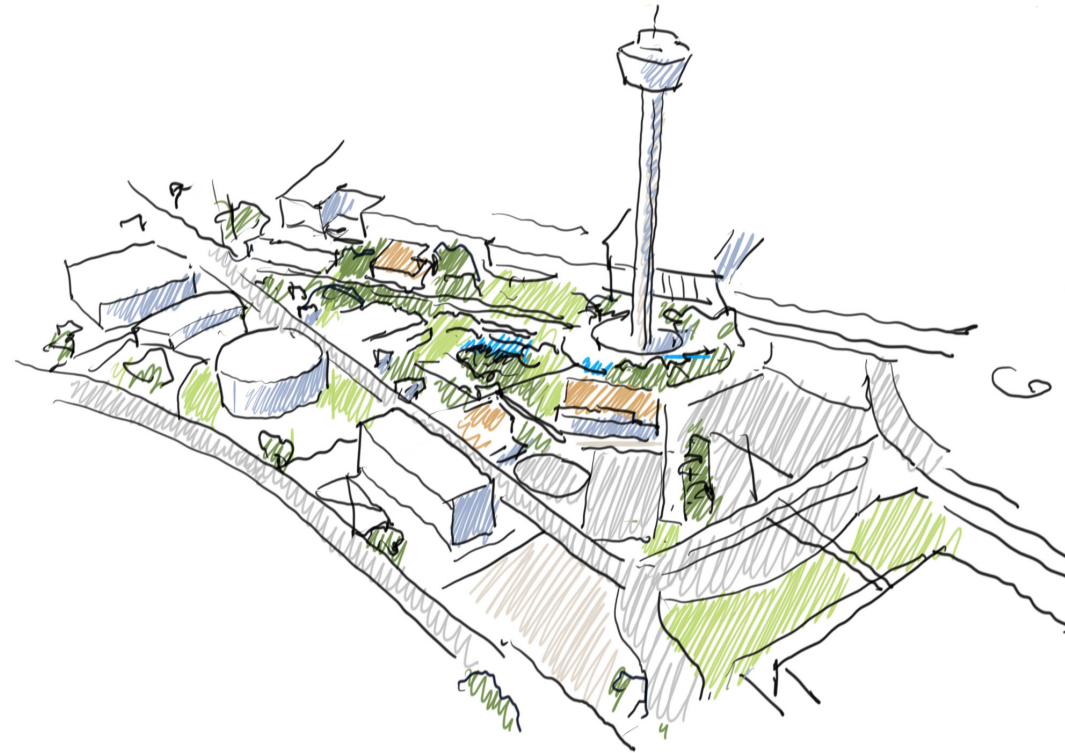



# Streets Framework

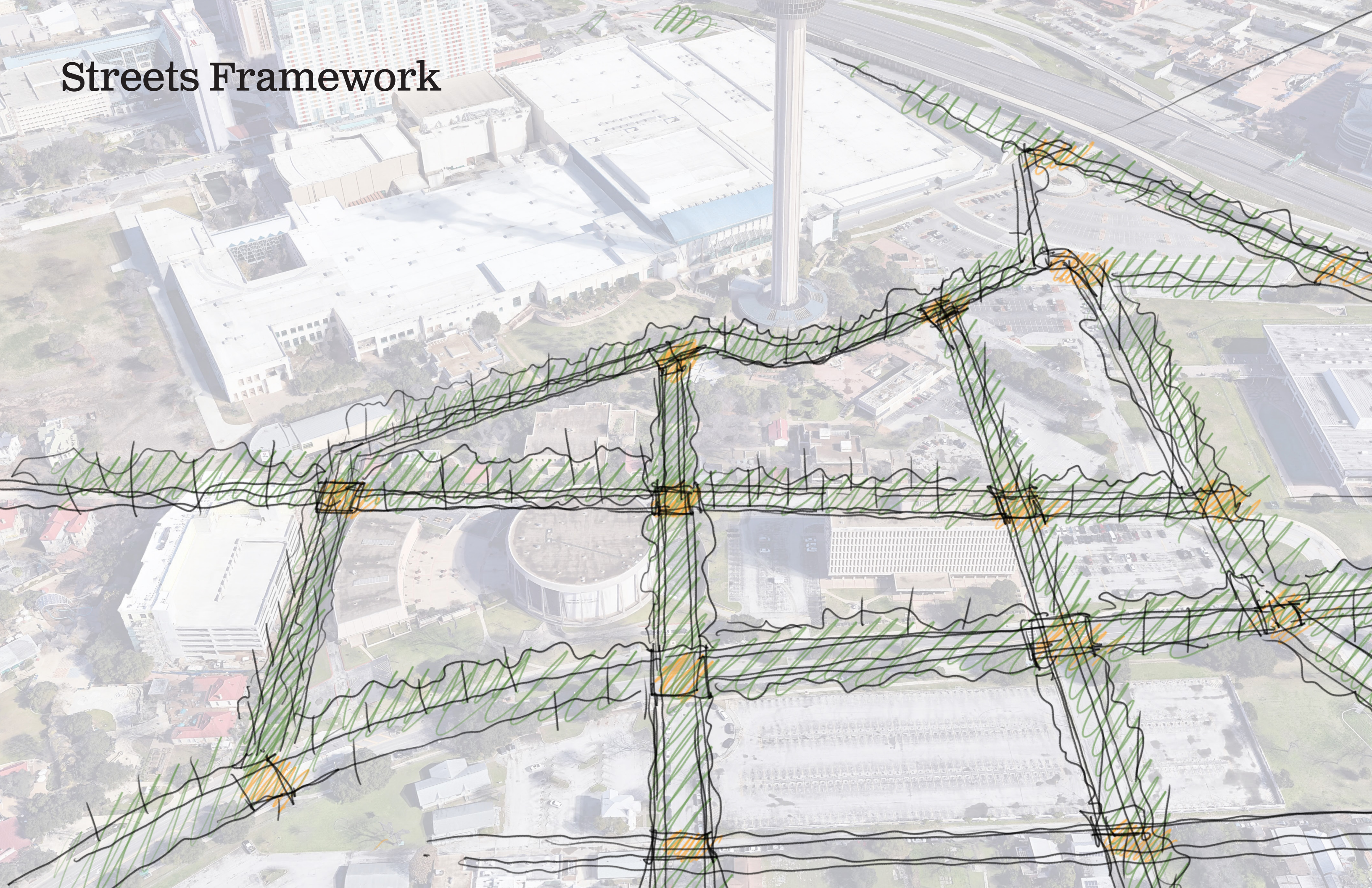





Current Nueva Street

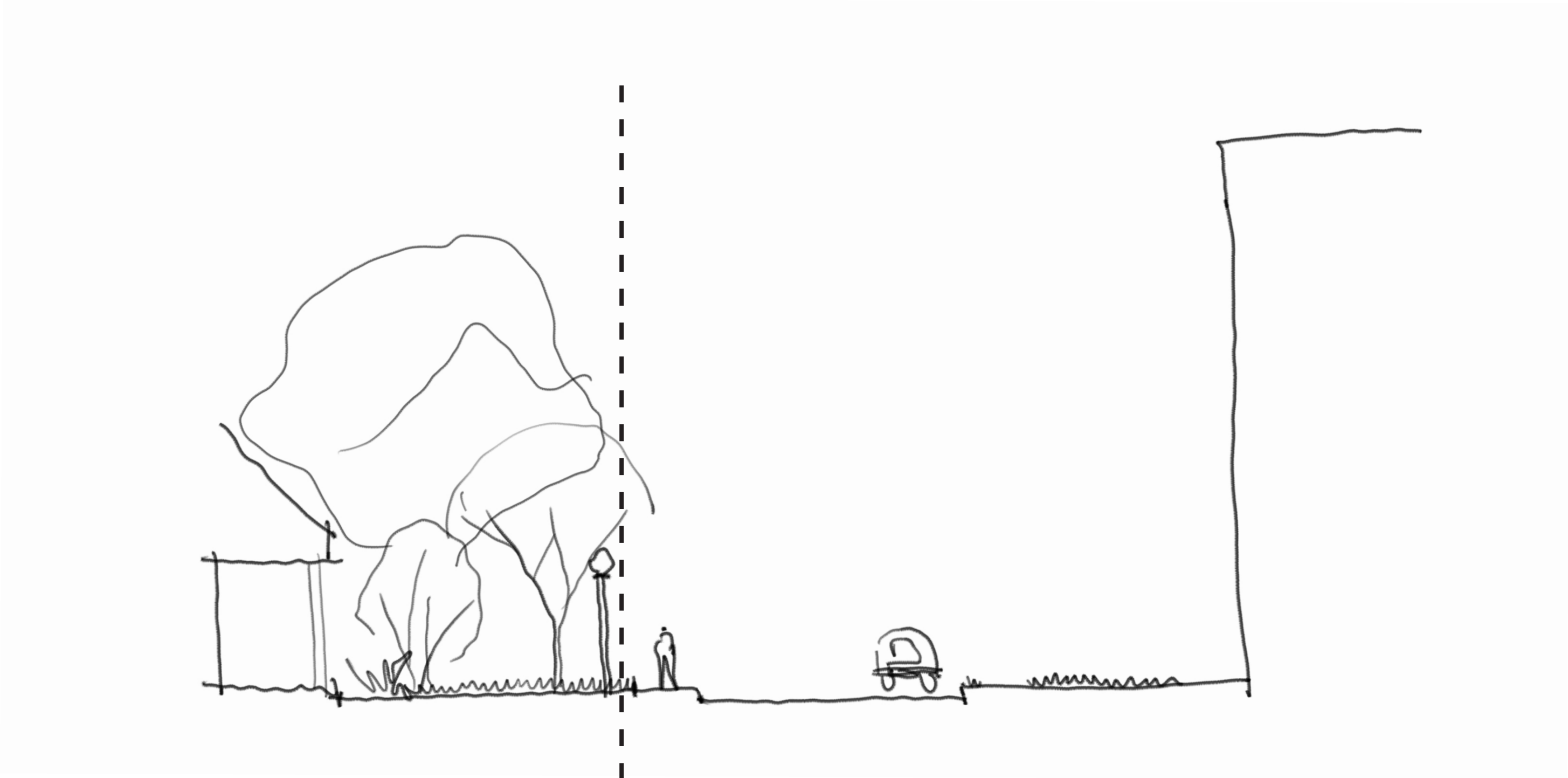



# Streets

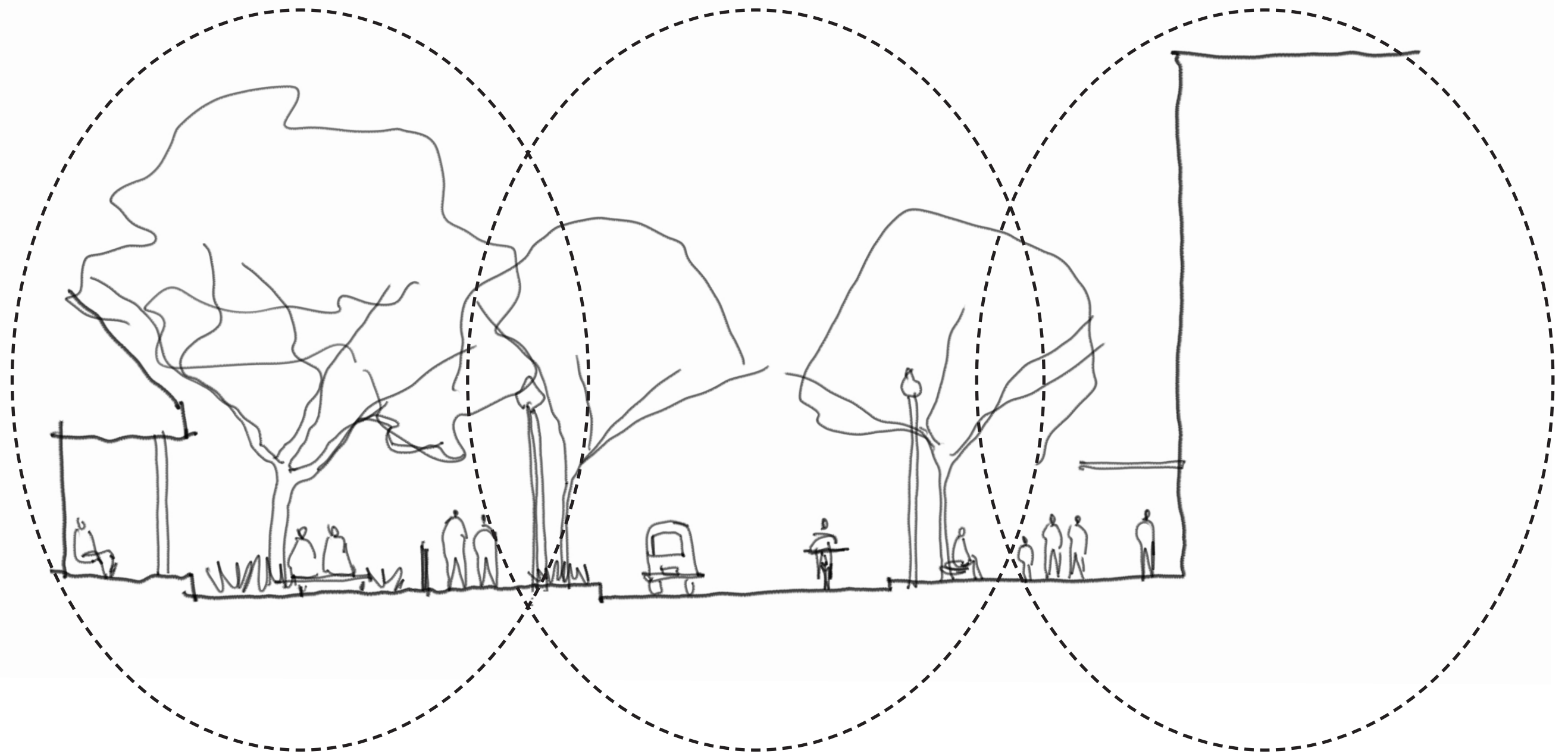



# Many Frontages

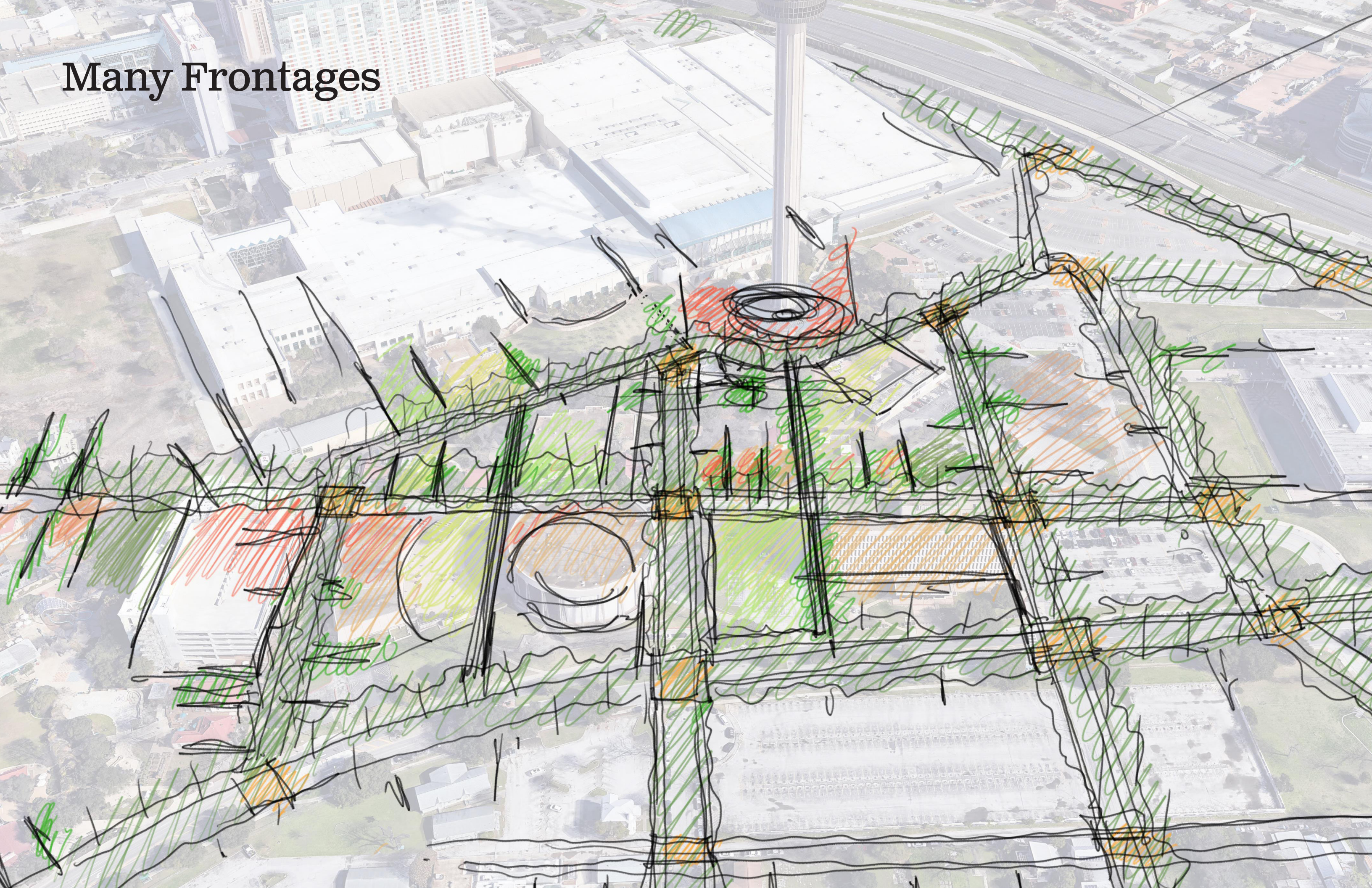



# Collective "Backyard"

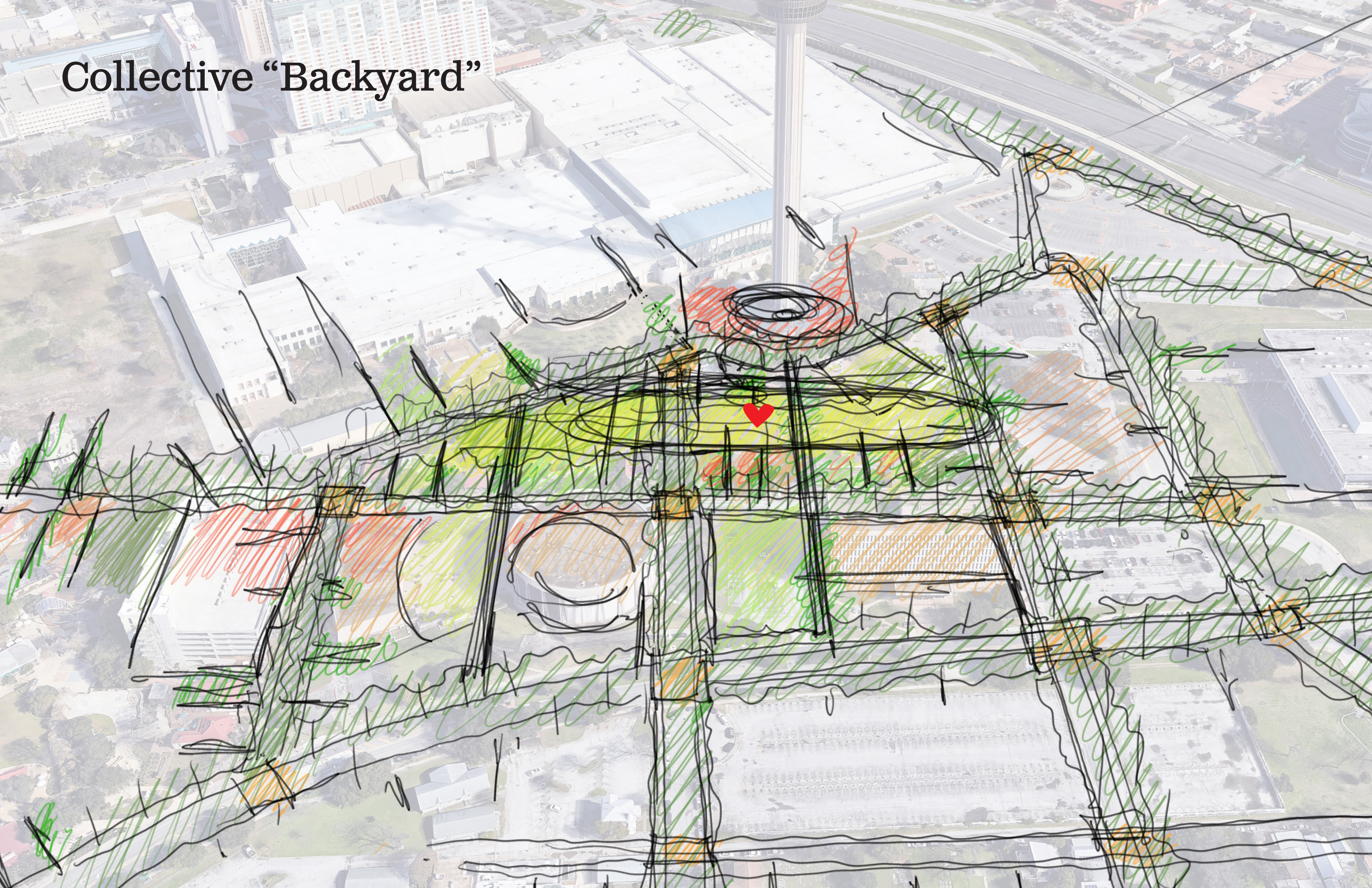

# Backyard



# Draft Concept Plan



# Streets, Lanes, Walks

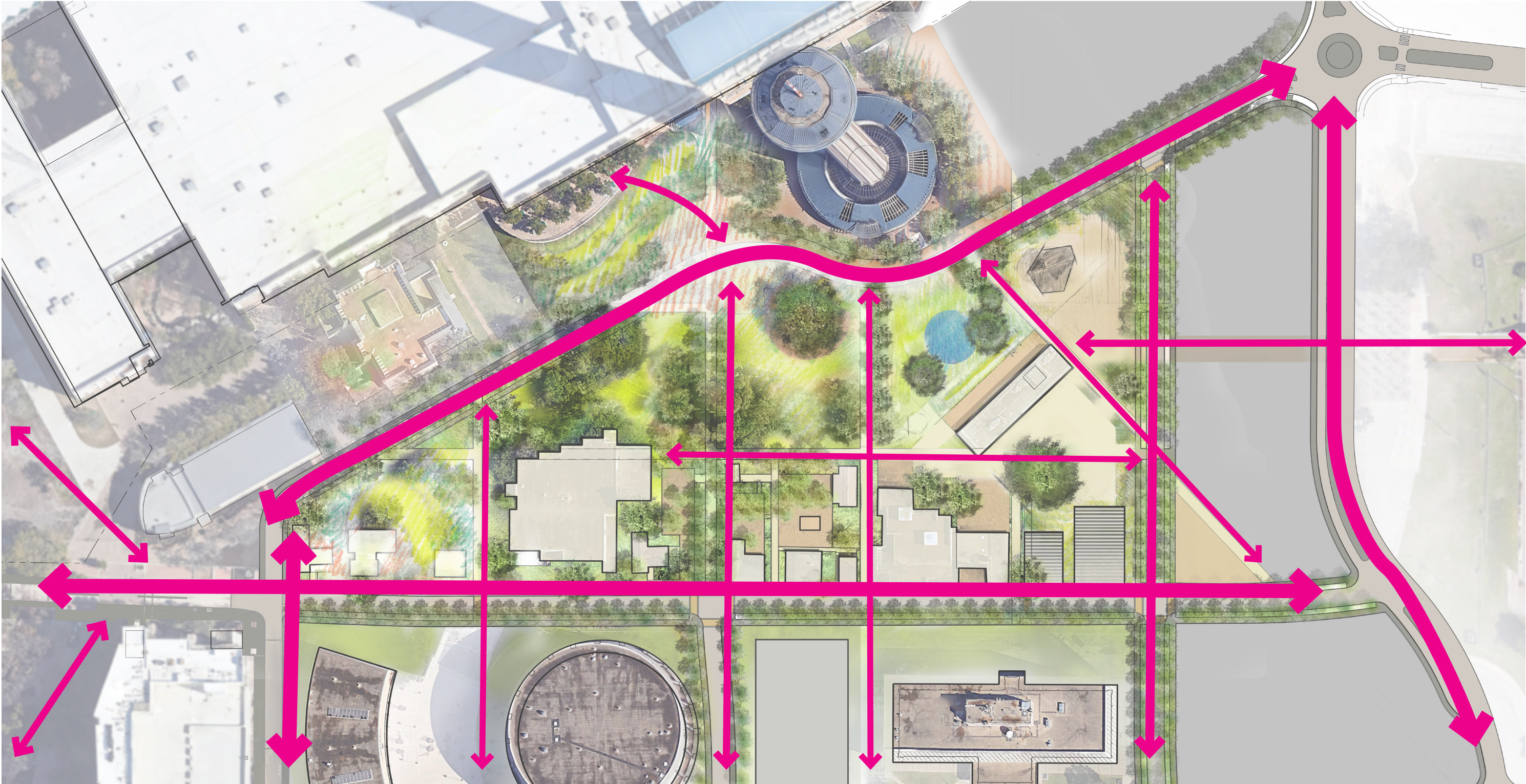



# Community Hub

Connecting destination activities with community opportunities

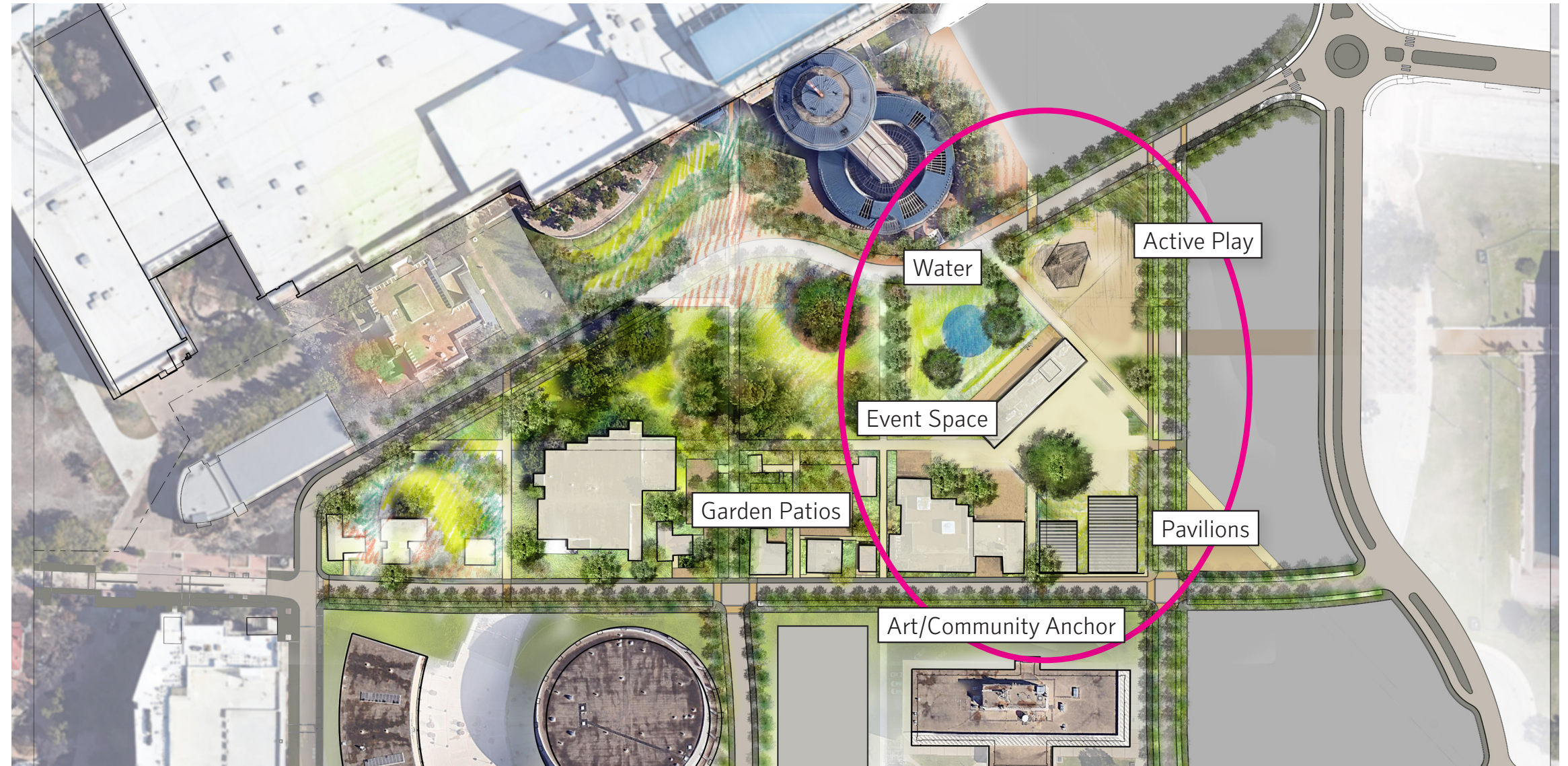

# Nueva Street

Neighborhood grain, mixed activities

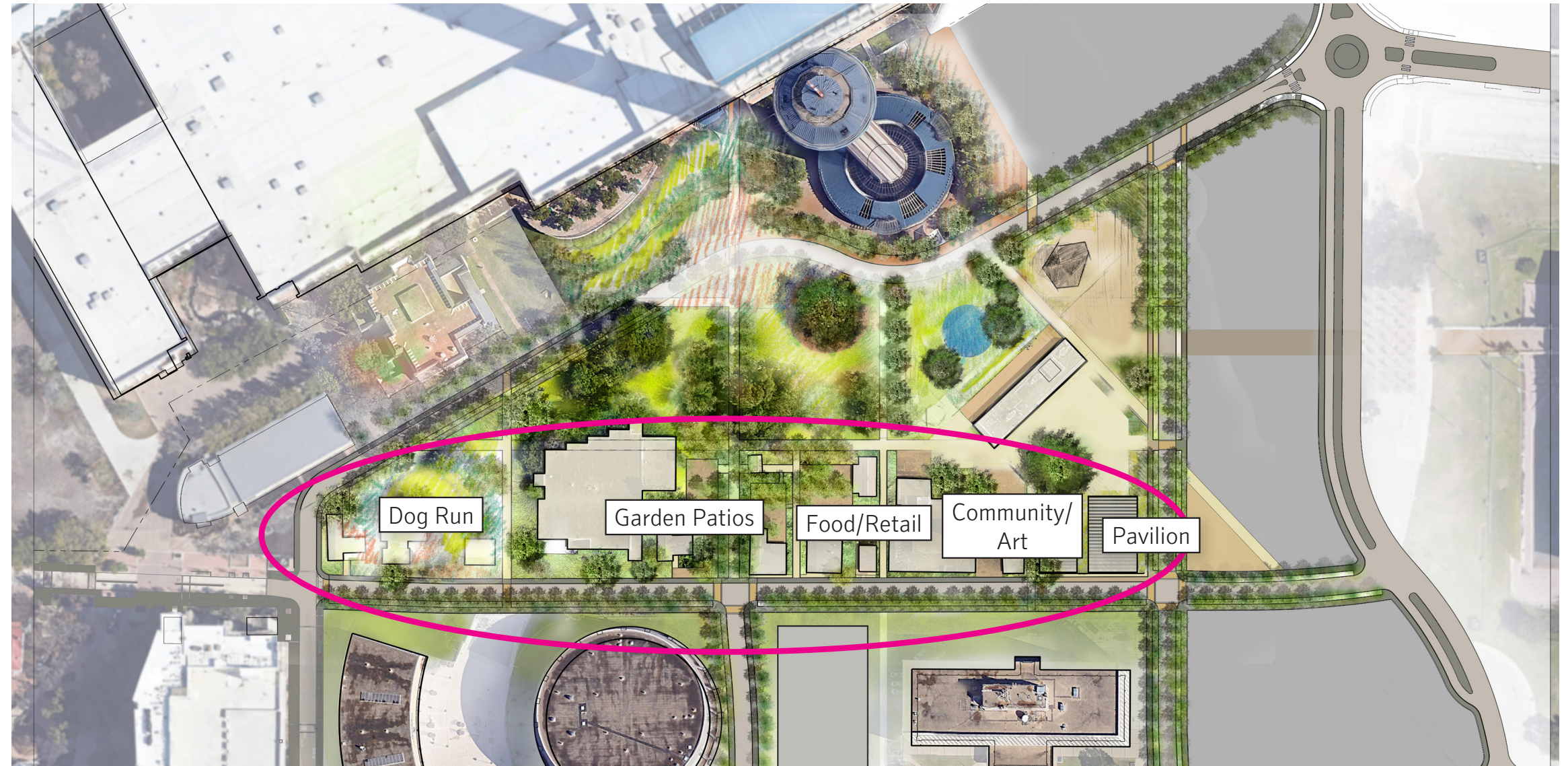

# Back Yard

Everyday collective park space

